

Financial Report

Lora Conger

Chief Financial Officer



“To serve our communities’ pre-hospital needs through value-driven, compassionate, and clinically superior care.”

GE Oil & Gas Building

6205 S. Sooner Road

- Two Buildings (South & West)
- Office Space: 35,400 ft²
- Warehouse: 42,600 ft²
- Total: 78,000 ft²

* Estimated Price: \$48.91/ft² =
\$3.81M

* Pending actual property line * Does not include grass lot
behind West Building *





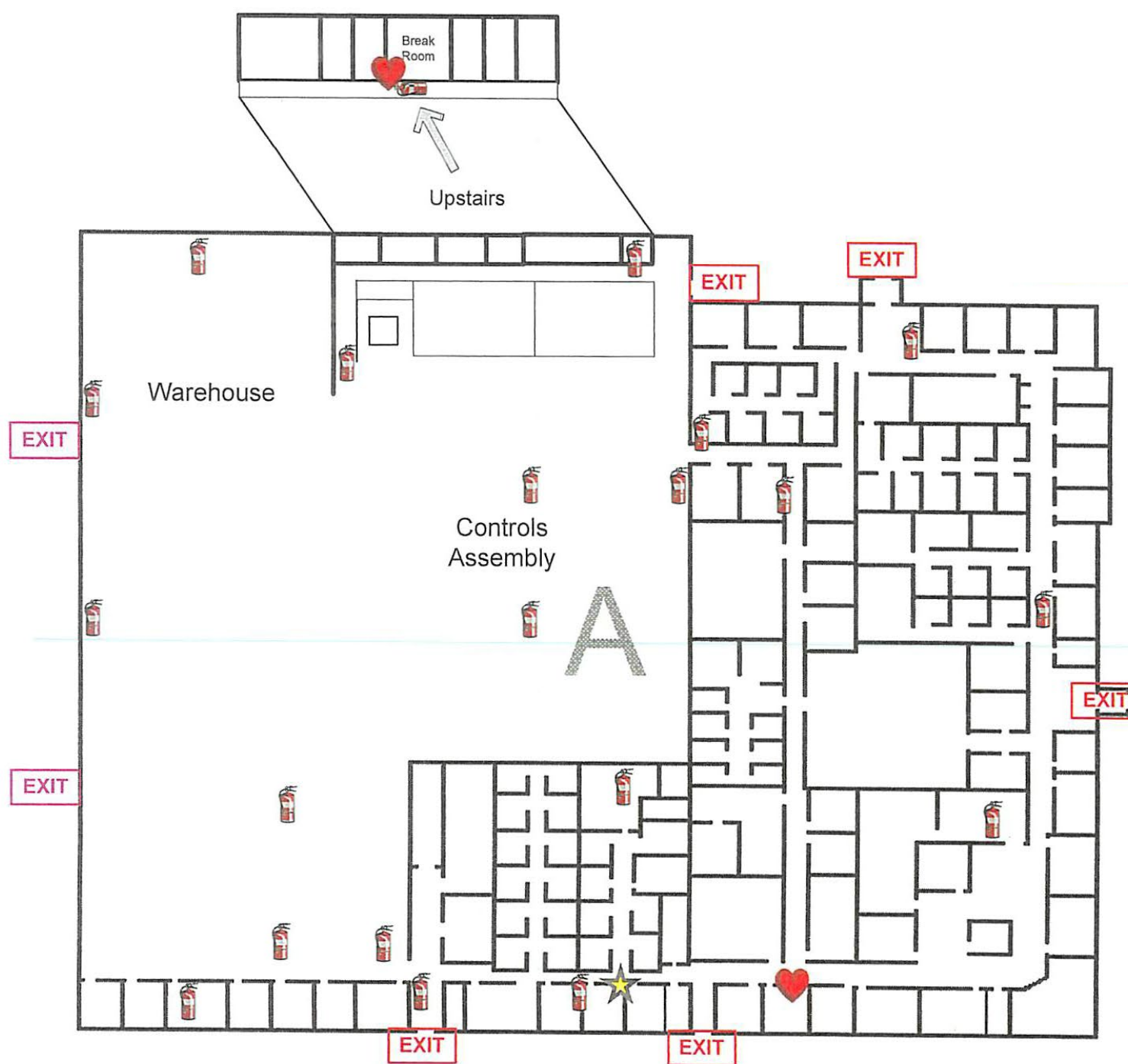

South Building

- Office: 30,300 ft²
- Warehouse: 24,900 ft²
- Total: 55,200 ft²
- Executive Offices
- Clear Height: 14'-18'
- Climate Controlled
- Drive-In Doors: 2





Building Map Legend

-  = Fire Extinguisher
-  = AED
-  = Emergency Exit
-  = Current Location (BLDG A)

In case of an evacuation emergency report to muster point (5)

West Building





- Office: 5,100 ft²
- Warehouse: 17,700 ft²
- Total: 22,800 ft²

- Clear Height: 20'
- Drive-In Doors: 4
- Compressed Air
- Climate Controlled





Building Map Legend

-  = Fire Extinguisher
-  = AED
-  = Emergency Exit
-  = Current Location (BLDG C)

In case of an evacuation emergency report to muster point (4)